



# Model 1-1/2, 1-1/2B and 1-3/4

## Ratchet Leverage Arbor Press

### Instruction and Parts list

#### MODEL 1-1/2

<u>Item</u>	<u>Part Name</u>	<u>Part No.</u>
1	Handwheel	167
2	3/8-16 x 3/8" Headless set screw	43586
3	3/8-16 x 5/8" Headless set screw	43589
4	Brake spring	108
5	Tinners rivet (1# per 1000)	43577
6	Ram (1 1/4" x 1 1/4" x 16 1/2")	147
7	Rest pin	174
8	Pawl	177
9	Pawl pin	175
10	Leverweight	176
11	3/8-16 x 5/8" Headless set screw	43589
12	3/8-16 x 5/8" Headless set screw	43589
13	Retaining ring	67424
14	Handle	179
15	Ram cap shims (.008")	145
16	Ram cap shim (.015")	146
17	Spindle	180
18	Ram cap	142
19	5/16" x 1" Hex cap screw	43315
20	Table plate assembly	700807
21	Main casting	172

#### MODEL 1-3/4

<u>Item</u>	<u>Part Name</u>	<u>Part No.</u>
22	Main casting	173
23	3/8"-16 x 1 3/4" Machine Bolt	43669

#### MODEL 1-1/2 B

<u>Item</u>	<u>Part Name</u>	<u>Part No.</u>
6	Ram (1 1/4" x 1 1/4" x 24 1/2")	191
15	Ram cap shim (.008")	434
16	Ram cap shim (.015")	435
18	Ram cap	188
19	3/8" x 1" Hex cap screw	43328
20	Table plate assembly	700941
21	Main casting	184

***Please contact factory for current prices.***

**Ordering information:** Please order all repair parts by part number and name, also mention model number of press. All parts are shipped F.O.B. Factory in Grand Haven, MI.

**Lubrication:** Keep all working parts of the press well oiled for easier operation. Also keep a light film of oil over the entire surface of the ram to prevent rust.

## DAKE

Division of JSJ Corp.  
724 Robbins Road  
Grand Haven, MI 49417

Phone: 616-842-7110 800-937-3253  
Fax: 616-842-0859 800-846-3253  
E-Mail: customerservice@dakecorp.com  
technicalservice@dakecorp.com  
Website: www.dakecorp.com

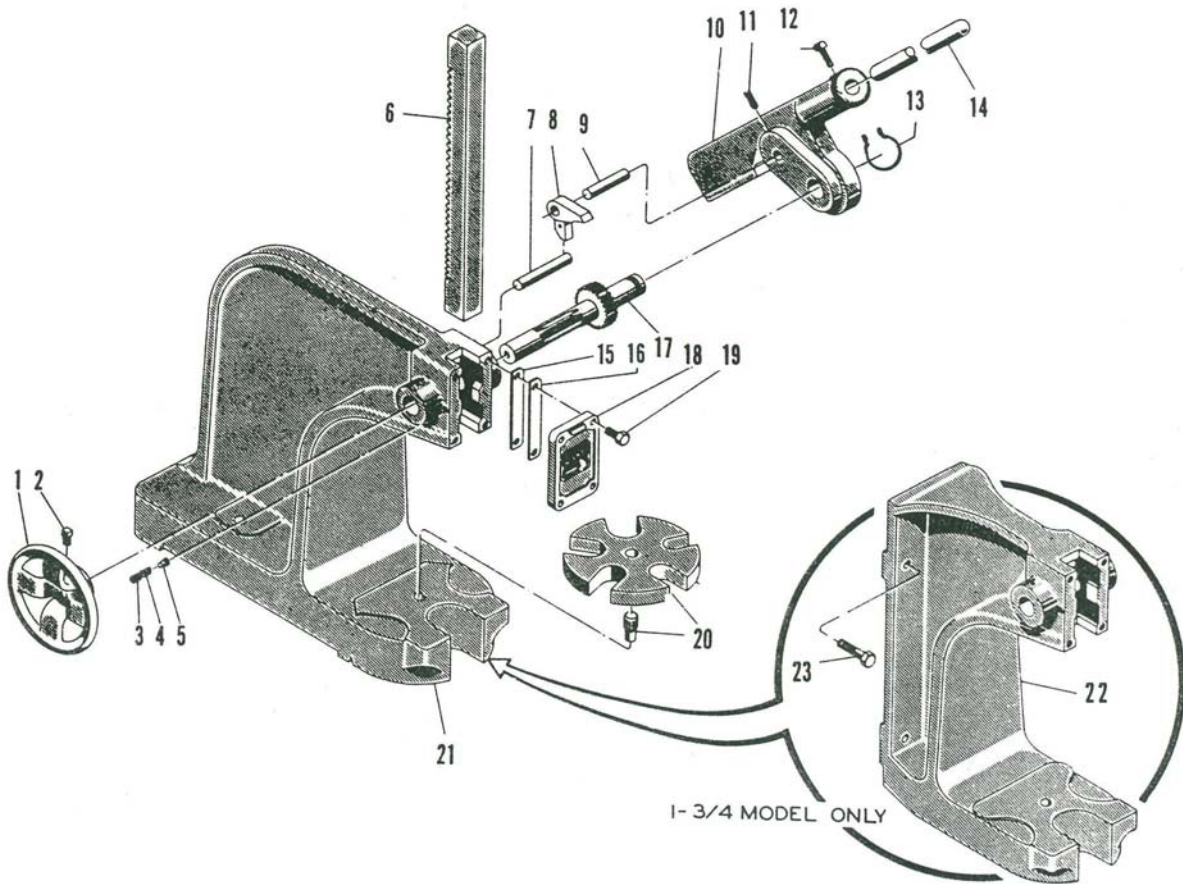

⚠ WARNING		
Establish solid footing to prevent falls.	Keep hand away from point of operation. Read instructions.	Guard workpiece to prevent projectiles from reaching operator. Wear eye protection.

⚠ WARNING
Equipment must be securely anchored to prevent tipping.



## SAFETY

**This is the safety alert symbol.** When you see this symbol on your press, be alert to the potential for personal injury.

### Follow recommended precautions and safe operating practices.

**Carefully read all safety messages in these instructions and on your press safety signs.** Keep safety labels in good condition. Replace missing or damaged safety labels.

**This machine is intended to be operated by one person.** This person should be conscious of the press ram movement not only for themselves but also for persons in the immediate area of the machine.

**Under no circumstances increase the leverage ratio of the press by using a longer handle or by placing a pipe over the handle.** Never hammer on top of the ram.